



Property Management Ltd



Chain Free

Allocated Parking

Modern fitted kitchen and bathrooms

0.4 miles to central line snaresbrook station

En-suite to master bedroom



Dickens Court Makepeace Road
London, E11

Guide Price £419,995

Living Room

Floor laid to newly laid grey carpet, spotlights to the ceiling, windows & radiator, access to kitchen

Kitchen

Newly Refurbished kitchen, floor laid to tiles, built in oven and hob with extractor fan, built in washing machine and dishwasher, freestanding fridge freezer.

Bedroom 2

Floor laid to newly fitted carpet, central ceiling light, window and radiator.

Family Bathroom

Floor laid to tiles, heated towel rail, bath with shower and shower screen, large vanity mirror.

En-suite

Floor laid to tiles, walk in shower, towel radiator

Master bedroom

Floor laid to newly fitted carpet, central ceiling light, window and radiator, entrance to en-suite

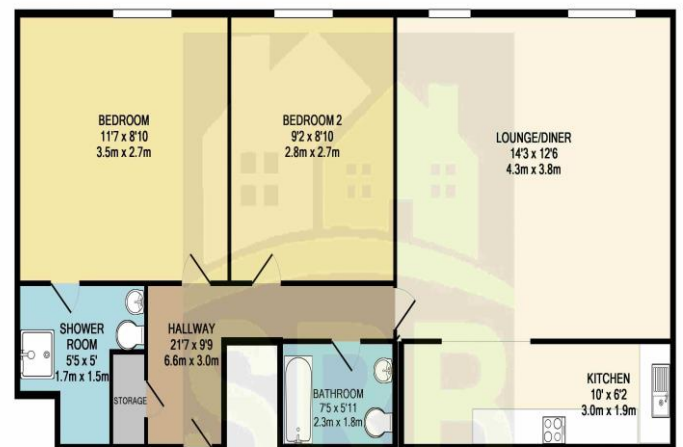
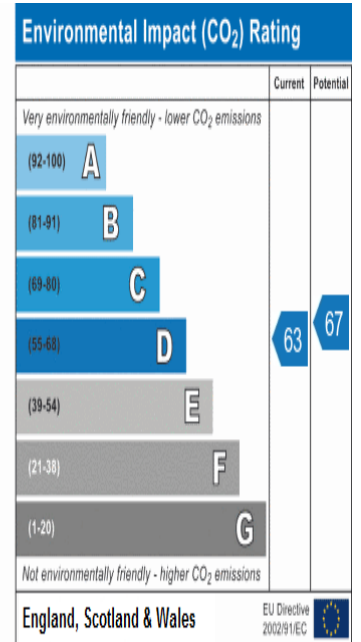
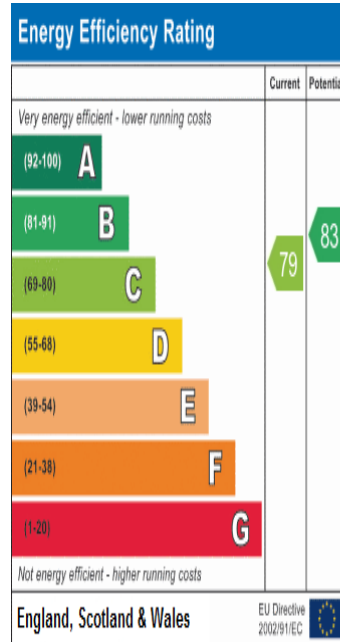

Whilst every attempt has been made to ensure the accuracy of the floor plan contained here, measurements of doors, windows, rooms and any other items are approximate and no responsibility is taken for any error, omission, or mis-statement. This plan is for illustrative purposes only and should be used as such by any prospective purchaser. The services, systems and appliances shown have not been tested and no guarantee as to their operability or efficiency can be given.
Made with Metropix ©2019

MONEY LAUNDERING REGULATIONS 2003

intending purchasers will be asked to produce identification and proof of financial status when an offer is received. We would ask for your co-operation in order that there will be no delay in agreeing the sale.

SRB Property Management Ltd
 27 Gobions Avenue, Romford, RM5 3SS
 Tel: 01708 76 77 99 | Email: enquiries@srbpropertymanagement.co.uk | Web:
 www.srbpropertymanagement.co.uk